

BUZZARD POINT
PEDESTRIAN
& BICYCLE
CIRCULATION



Figure 12: Access and Circulation of Pedestrians (without South Capitol Street Oval)

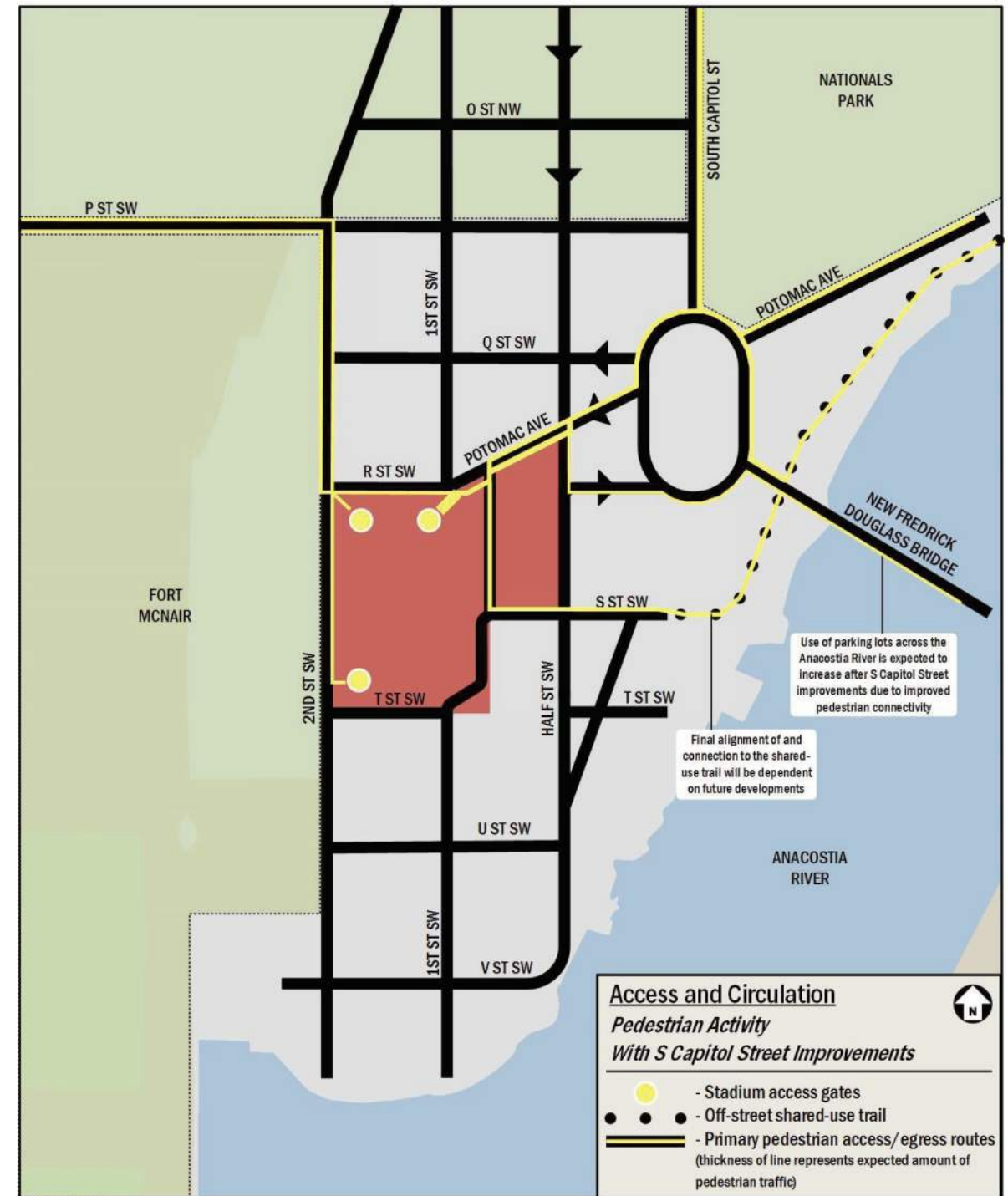

Figure 13: Access and Circulation of Pedestrians (with South Capitol Street Oval)



Figure 14: Access and Circulation of Bicyclists (without South Capitol Street Oval)



Figure 15: Access and Circulation of Bicyclists (with South Capitol Street Oval)

ENTRY GATE 2

15%
2,910 FANS

75%
14,550 FANS

ENTRY GATE 1

PREMIUM SPACE
ENTRY

10%
1,940 FANS

ENTRY GATE 3

BIKE VALET

PRIMARY FAN CIRCULATION

SECONDARY FAN CIRCULATION

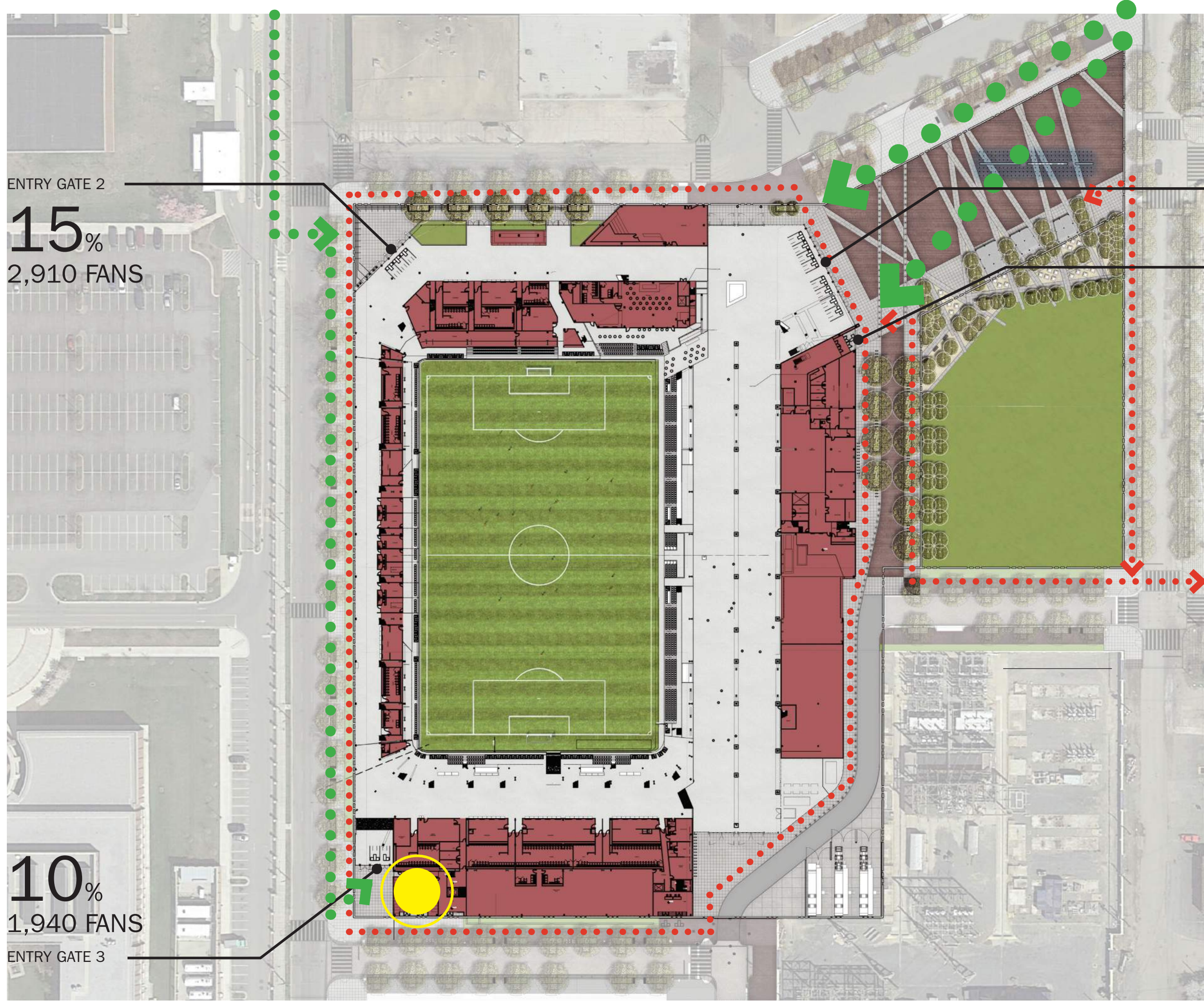

BUZZARD POINT
TRUCK LOADING
AND TURNING
STUDY



Figure 3: Access and Circulation for Stadium Loading Activity (without South Capitol Street Oval)

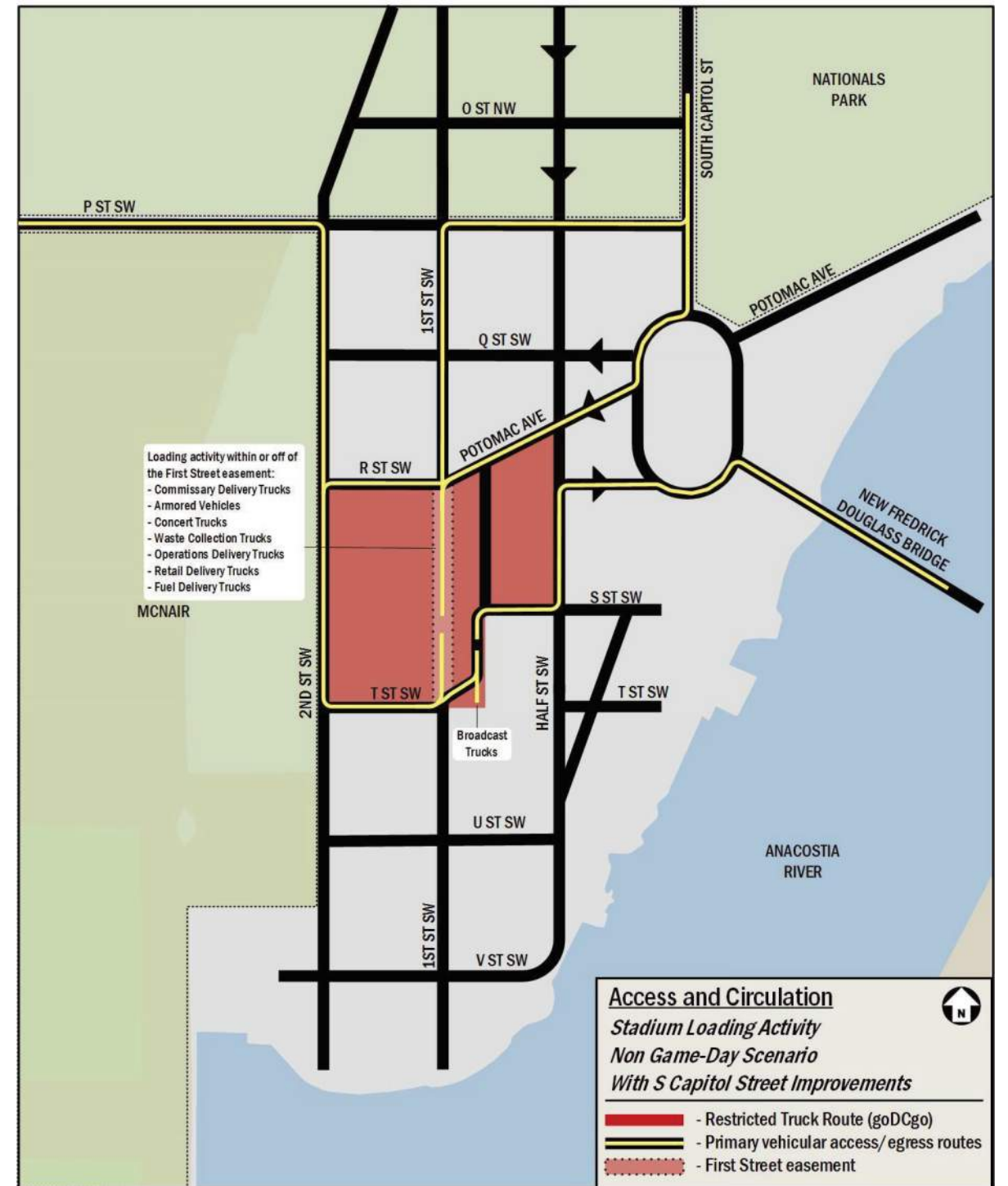
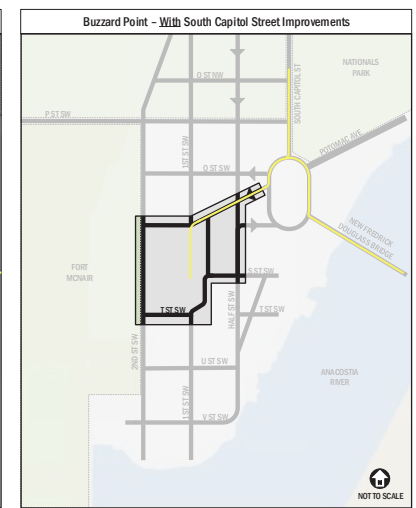
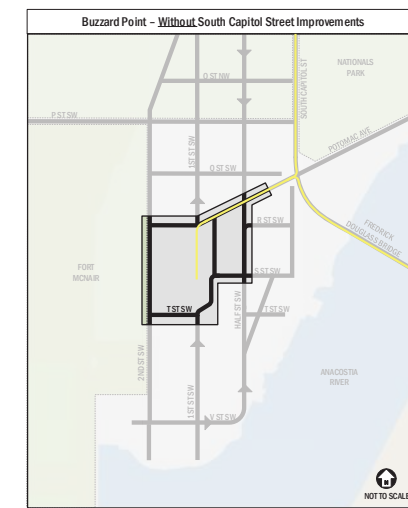
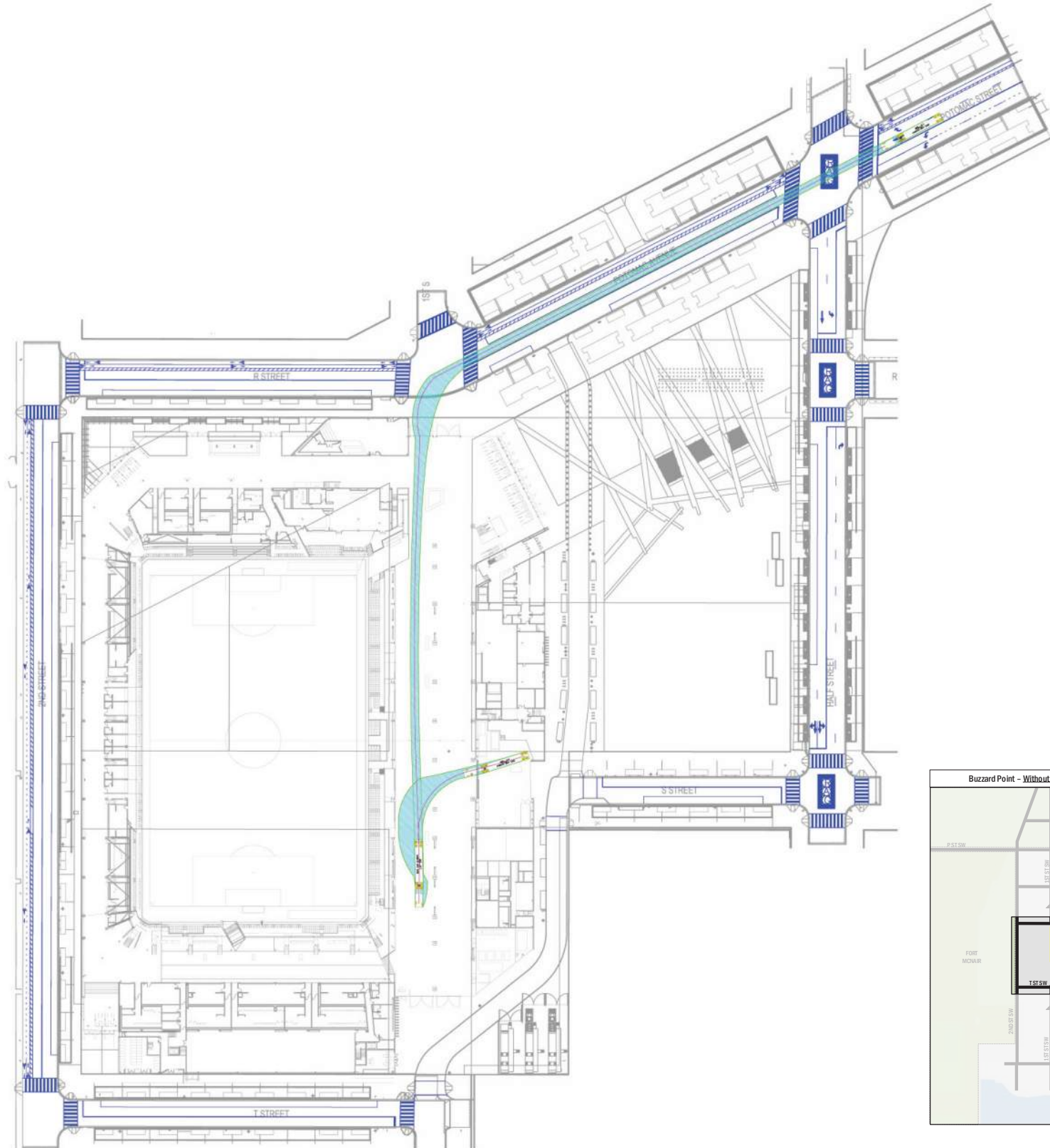
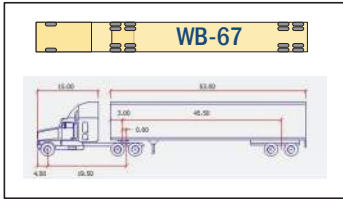
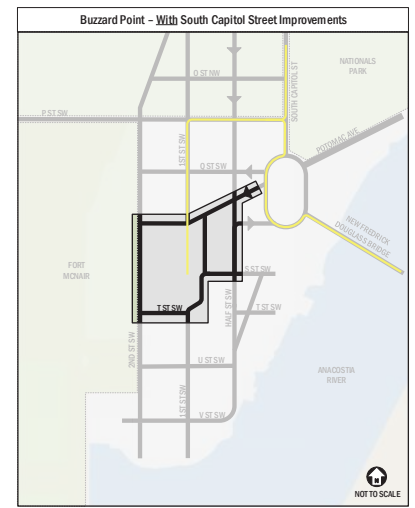
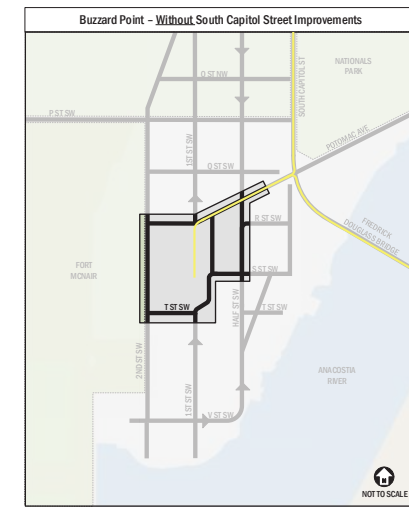
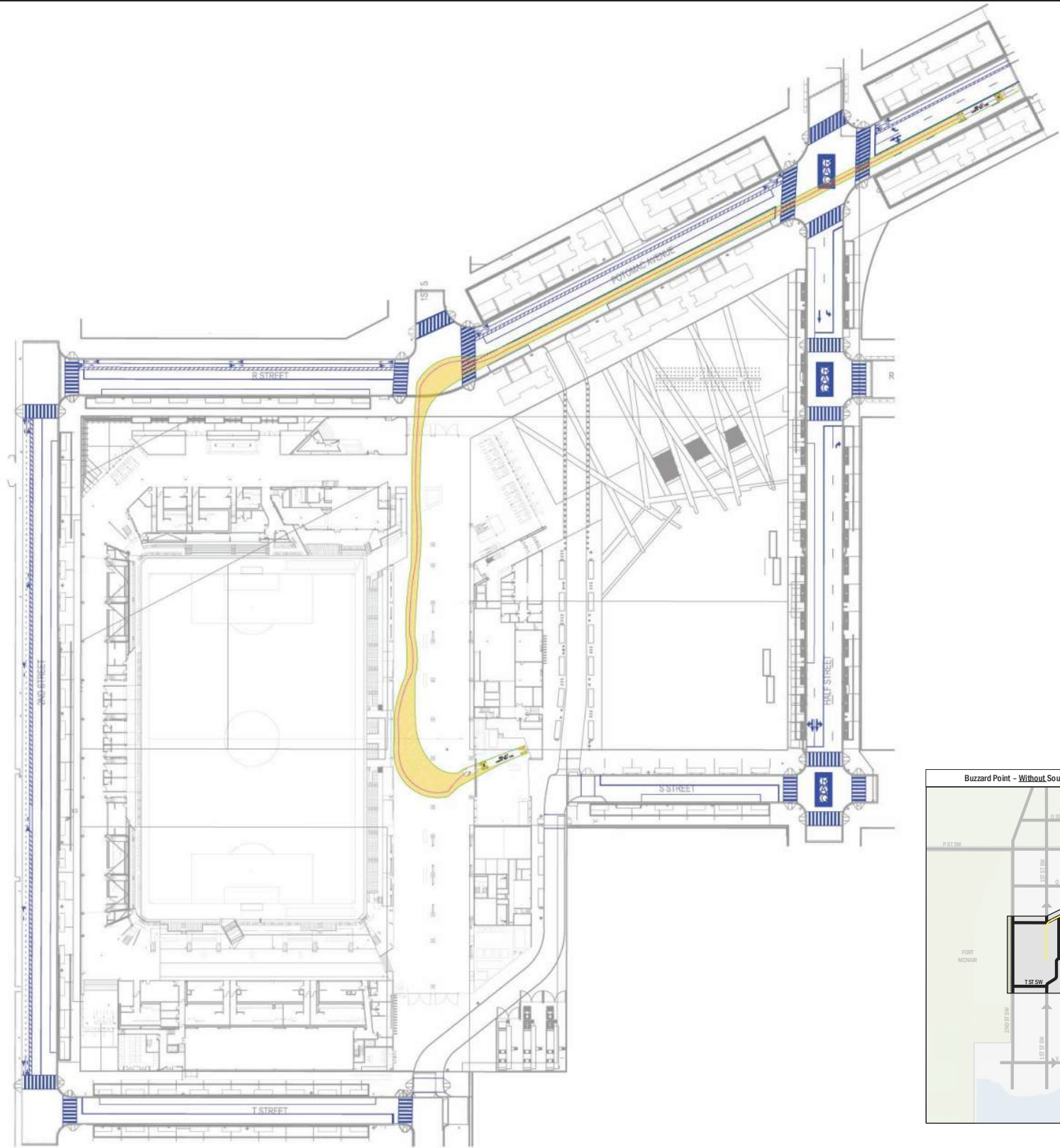
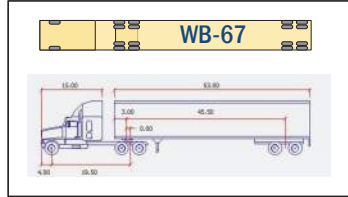
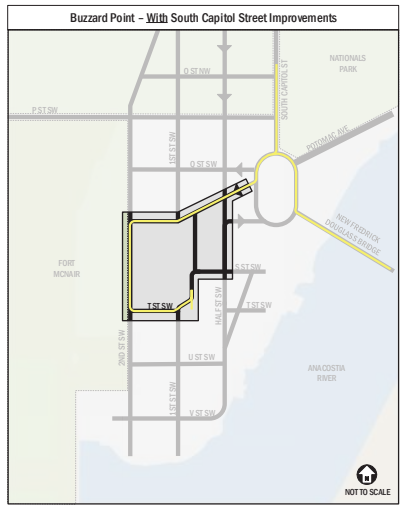
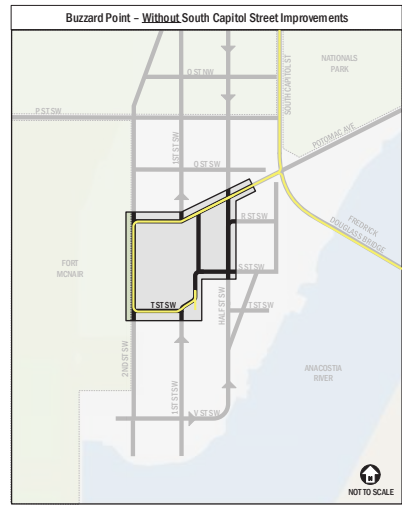
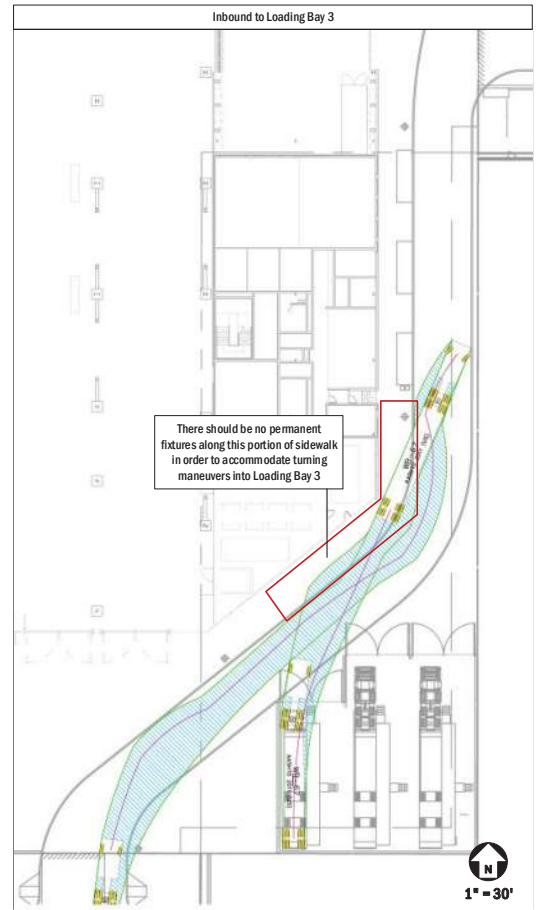
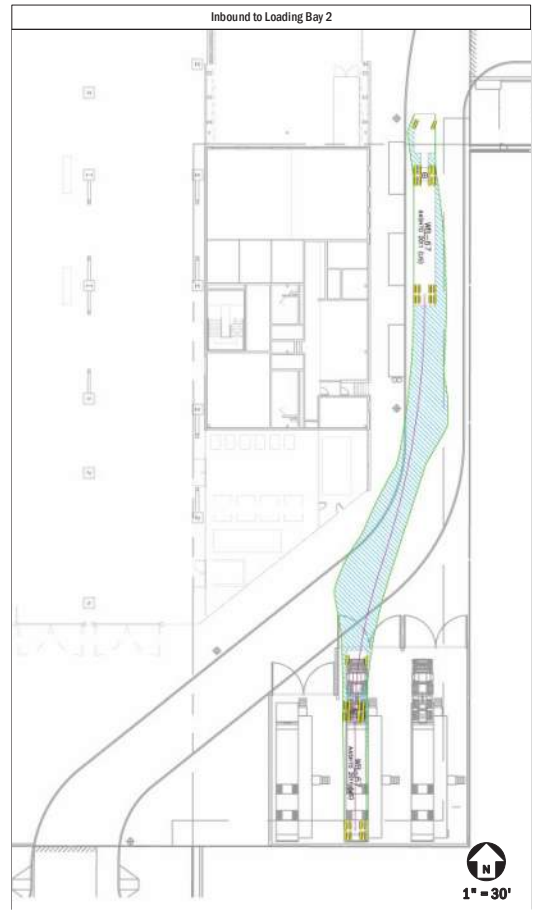
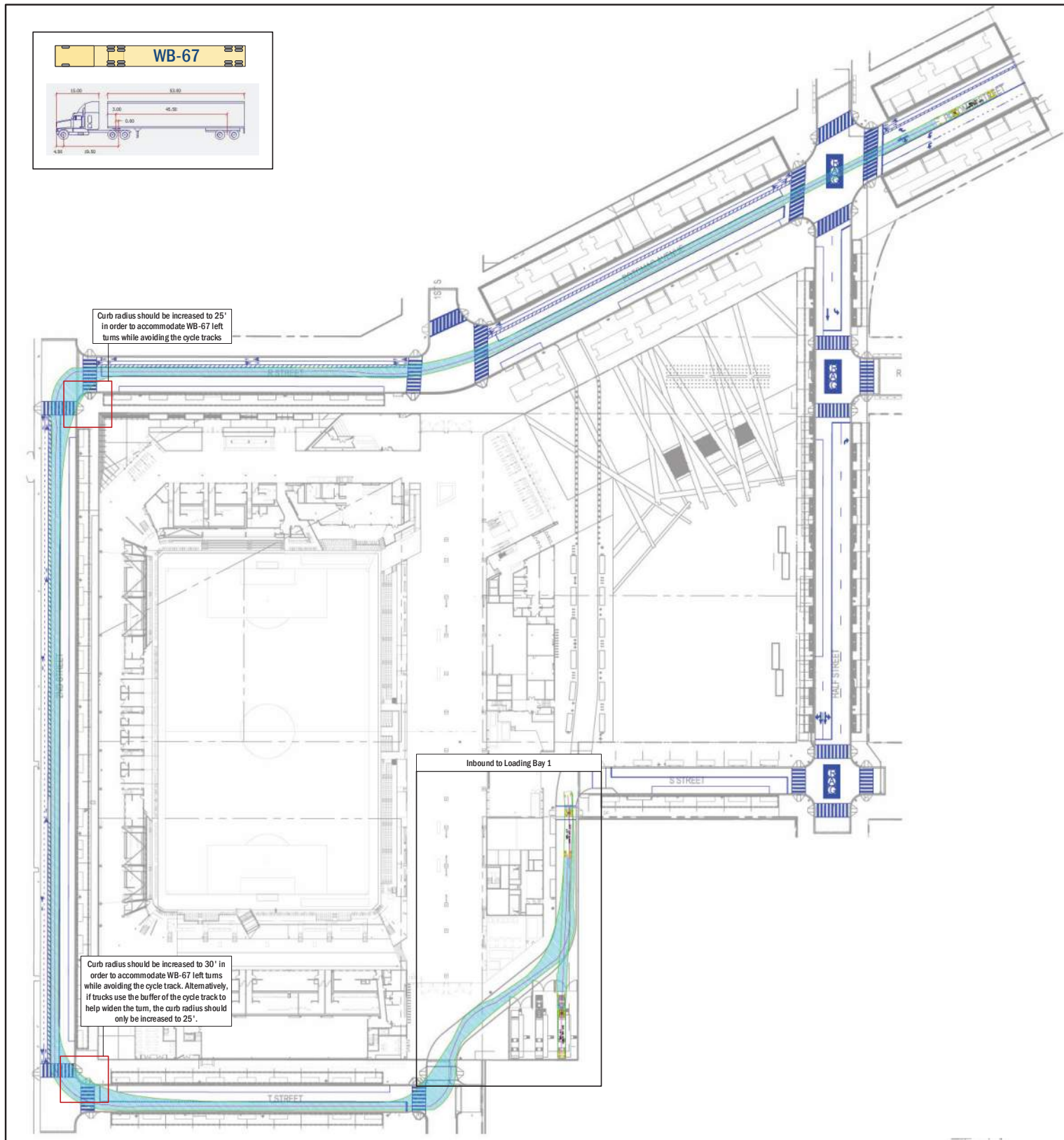
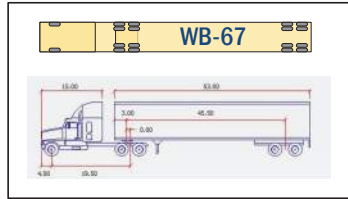
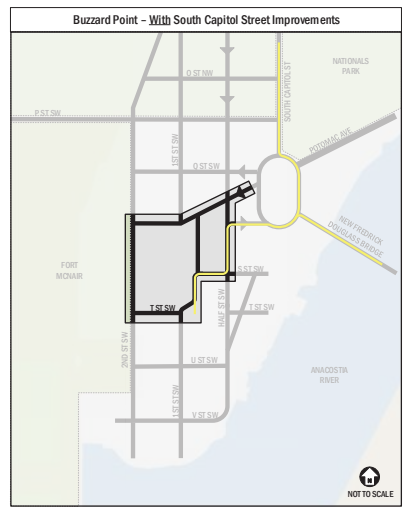
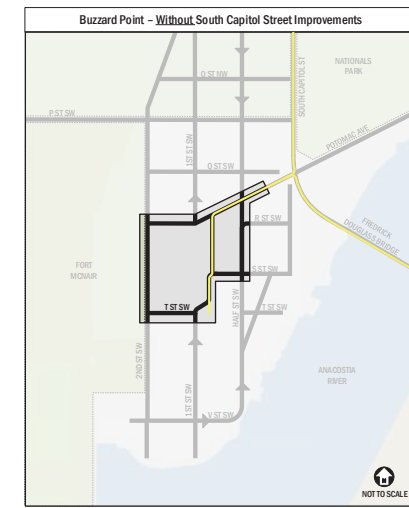
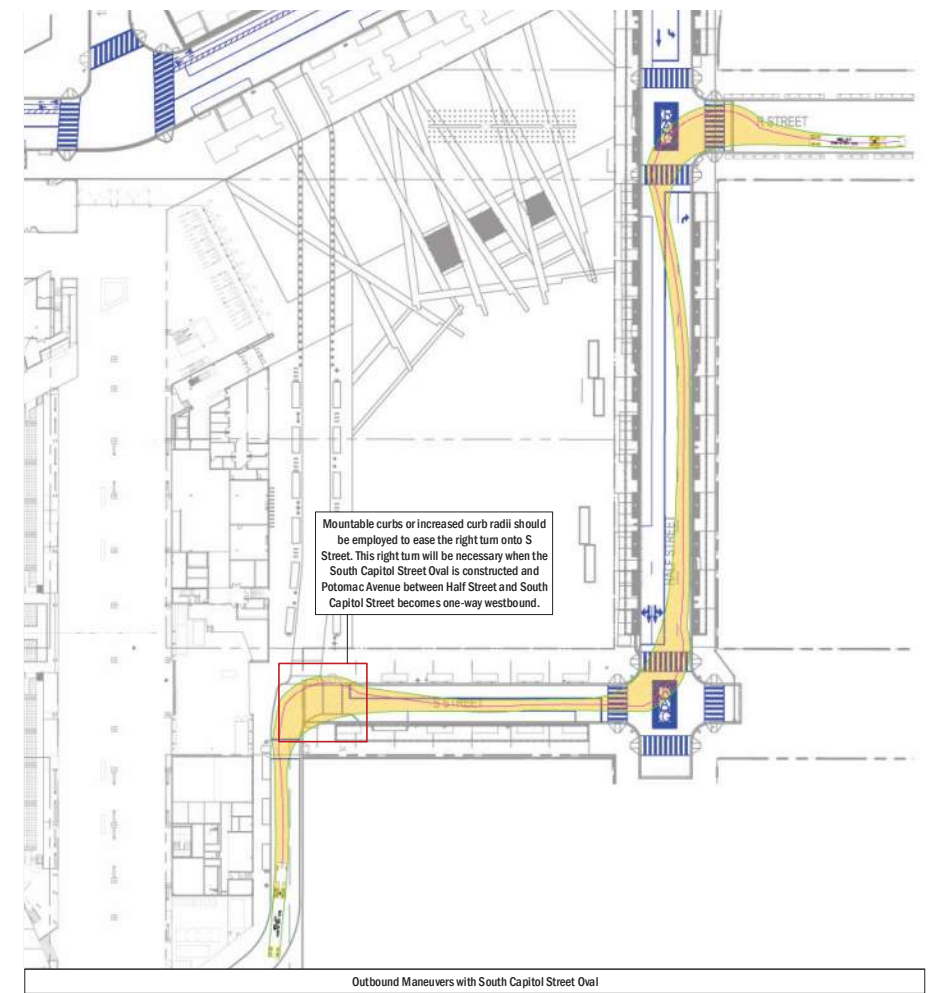
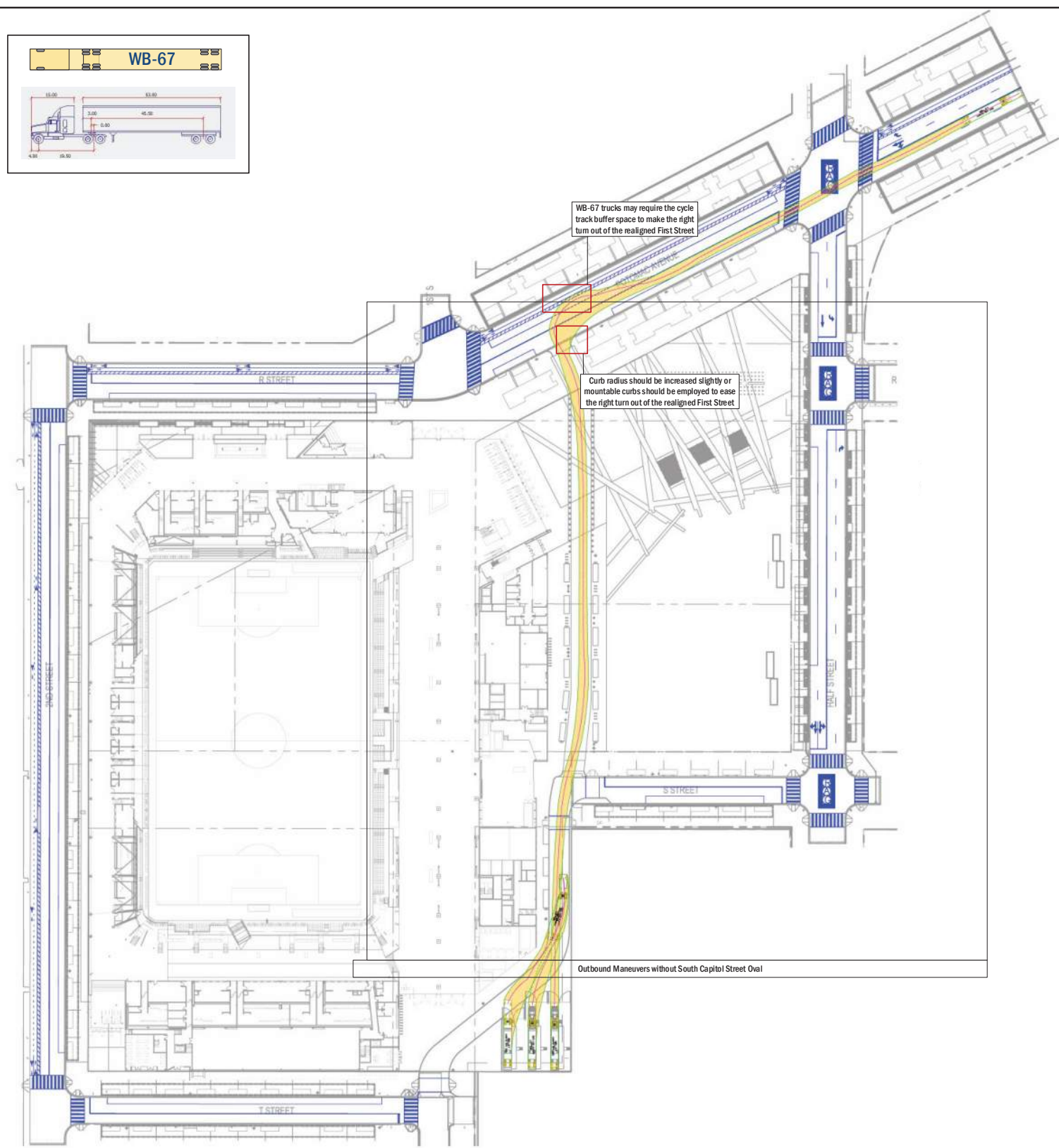
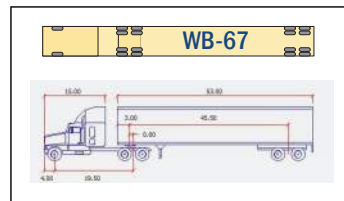

Figure 4: Access and Circulation for Stadium Loading Activity (with South Capitol Street Oval)









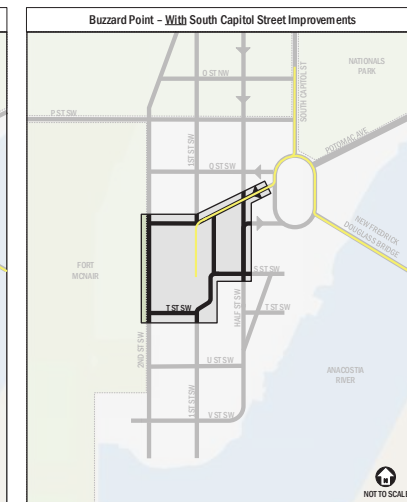
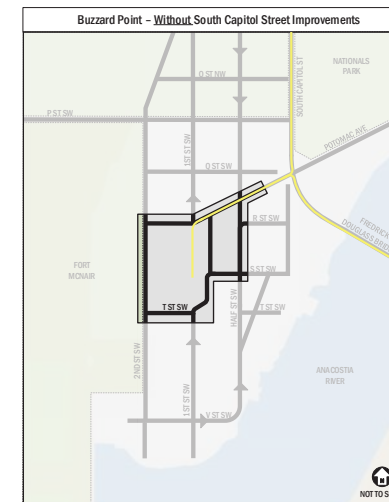
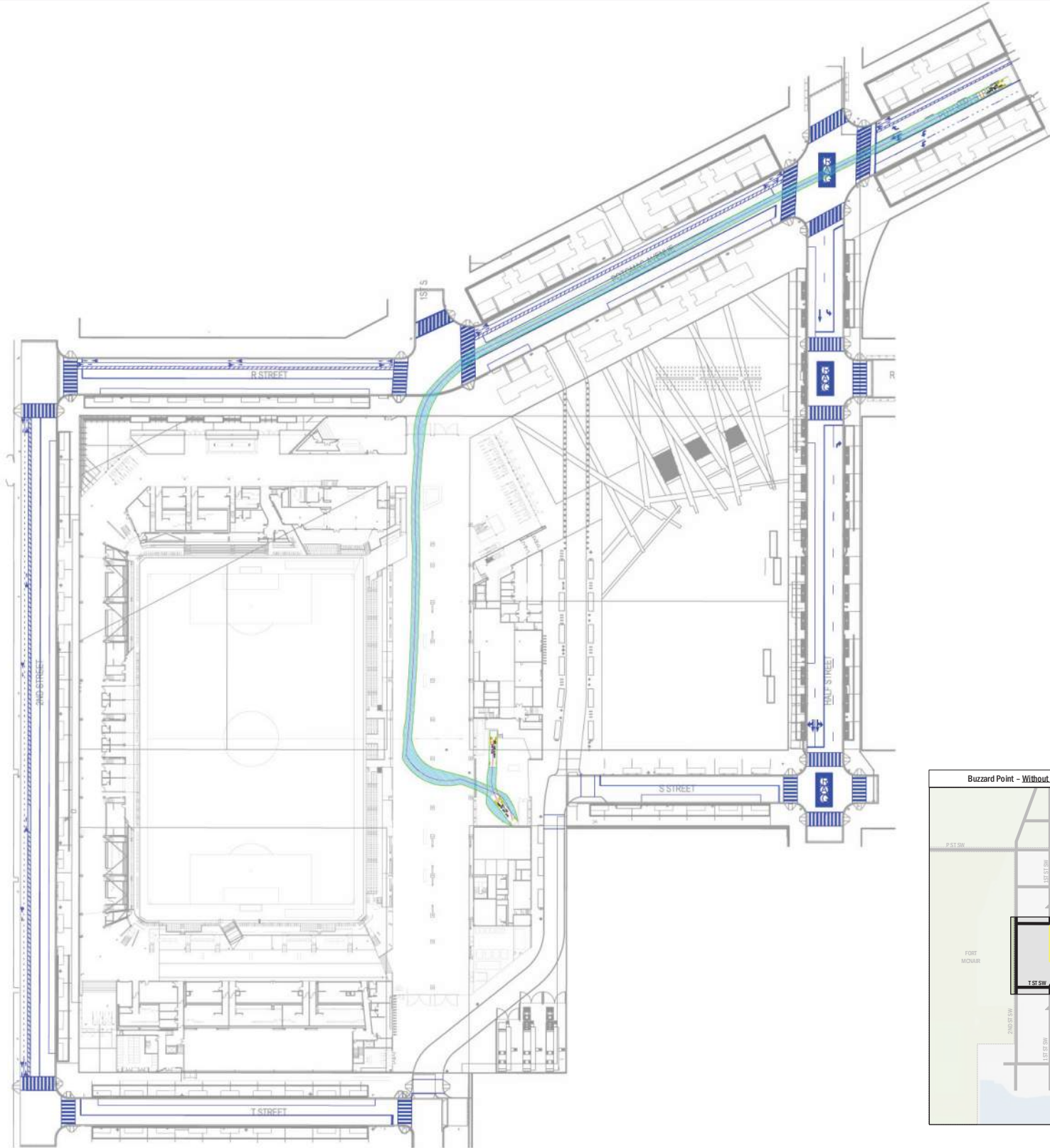
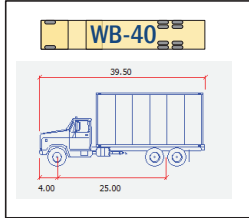

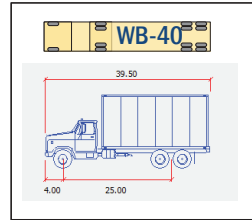

Outbound Maneuvers without South Capitol Street Oval

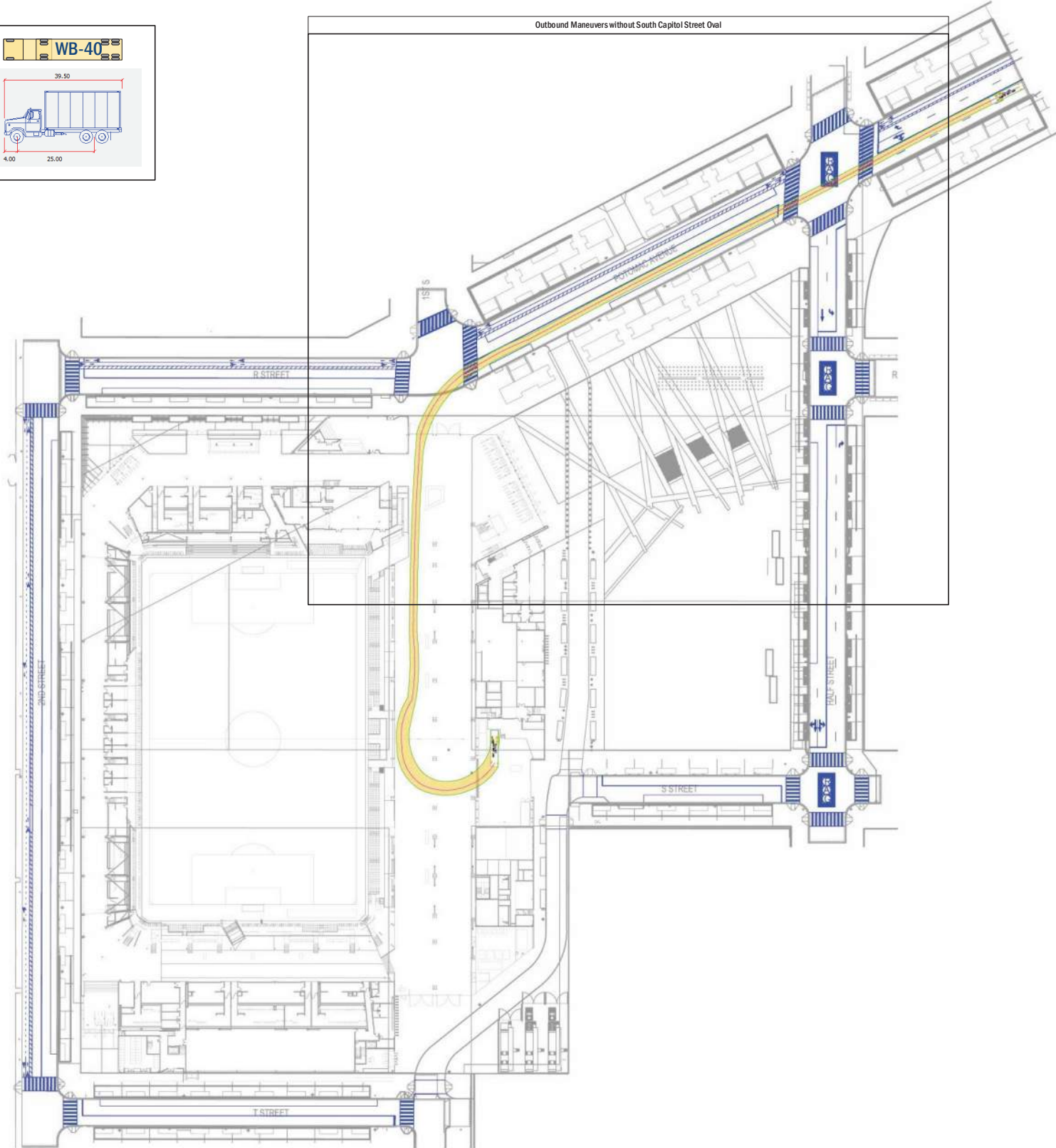

Outbound Maneuvers with South Capitol Street Oval

